



## PNX-PLBS96AE

## Passenger Loading Bridge Stair Specifications

### Structure:

- \* Main Structure-1 1/4" structural steel tubing
- \* Stair treads aluminum diamond plate
- \* Platform aluminum diamond plate
- \* 5.70 x 8" Pneumatic wheels-front/7" casters in back
- \* Rear stabilizer
- \* Stair and platform have non-skid surfaces

### Platform:

- Main - 45" X 60"
- Intermediate - 36" X 36"

### Options:

- Aluminum Canopy
- Wheel Chocks
- Solar Charger
- 110 Volt Lighting

### Shipping Dimensions:

- 224" lg. X 96" wide X 72" high
- 3000 Lbs.

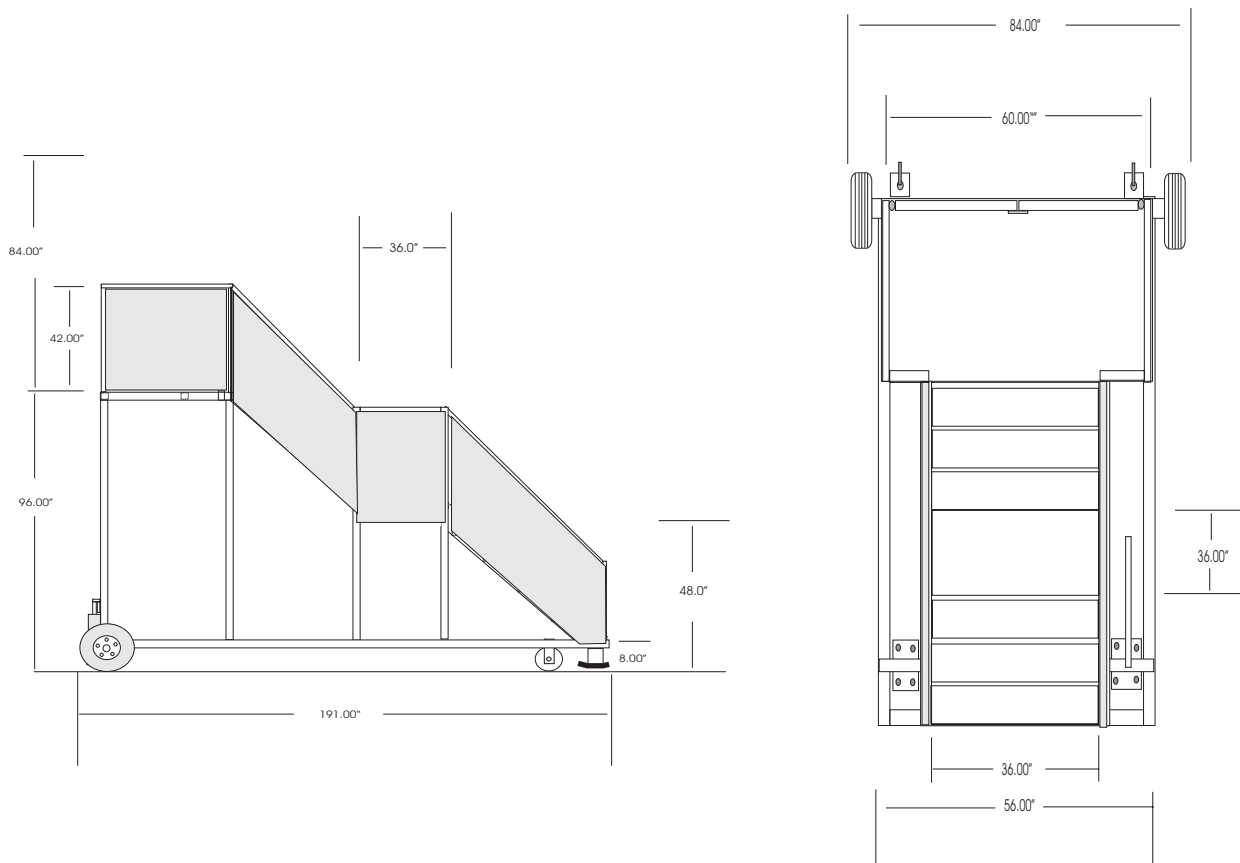

**Phoenix Metal Products 3000 Industrial Avenue 3 Ft. Pierce, Fl. 34946**

**Ph 772-595-6386 Fax 772-595-6389**

**Email Address: [phoenixgse@earthlink.net](mailto:phoenixgse@earthlink.net)**

**URL: [www.phoenixgse.com](http://www.phoenixgse.com)**