



PNX-PPS96/150

PASSENGER STAIR



The Phoenix Metal Products, Inc. PPS96/150 is a parallelogram stair that services commercial aircraft with doorsills from 97" to 150". The PPS96/150 is a non-motorized vehicle with 5th wheel steering axle and 4.00 x 8.00 solid tires and wheels. A towbar is standard to transport to remote areas. Both sides of the platform have fully retractable wings and the stair section has modesty shields and lights for night operations. The light system has a battery, charger and solar panel. Non-marring bumpers protect all surfaces that contact the aircraft. The chassis of the stair is constructed of heavy wall structural tubing. The stair and platform are made using structural aluminum tubing with formed aluminum stair tread risers. A hydraulic cylinder powered by a hand pump raises the platform. The stair is locked into position with safety latches on both sides of the "A" frame.

Phoenix Metal Products 3000 Industrial Avenue 3 Ft. Pierce, FL. 34946
Ph 772-595-6386 Fax 772-595-6389
Email Address: phoenixgse@earthlink.net URL: www.phoenixgse.com

PNX-PPS96/150

PASSENGER STAIR

SPECIFICATIONS

1. Structure

- 1.1 Chassis Gauge Structural Steel Tubing
- 1.2 Stair Section All Aluminum
- 1.3 Non Skid Stair Steps
- 1.4 Adjustable Top Platform Handrails to Allow for Aircraft Door Opening
- 1.5 Front and Rear Solid Tires

2. Features

- 2.1 Stair Lighting with Battery and Charger
- 2.2 Hand Operated Pump for Hydraulic System
- 2.3 5th Wheel Steering
- 2.4 Front Hydraulic Stabilizer, Solid Tires
- 2.5 Aluminum Hand Rails

Options

- 3.1 Solar Charging System
- 3.2 FiberGrate Walking Surface
- 3.3 LED Lighting

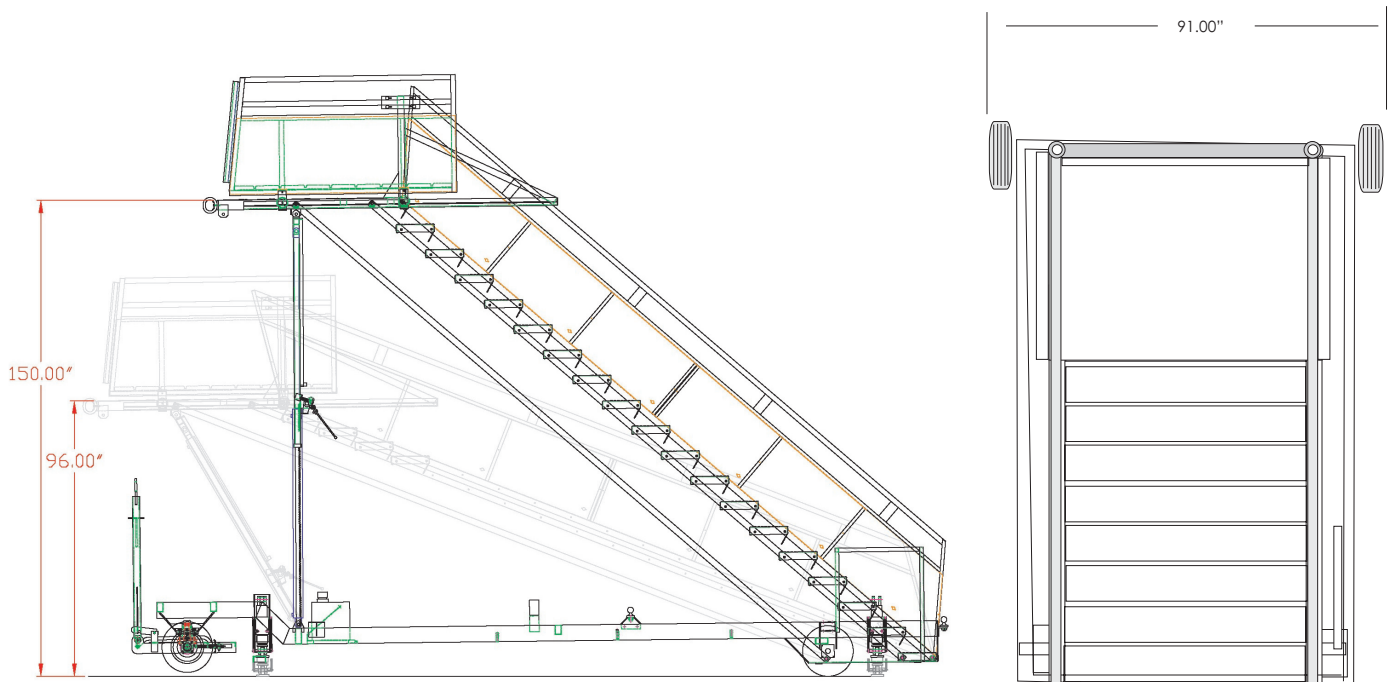

Specification Subject to Change Due to Product Improvement