

PHOENIX

METAL PRODUCTS, INC.



The Phoenix PLBS 96AE is a fixed passenger stair designed to be used at a passenger loading bridge to transport passengers from ramp level to terminal entry. The PLBS 96AE is lighted for night operations. The platform has safety gates to secure the opening at the loading bridge bumper. The stair has two adjustable stabilizers in the front and two fixed stabilizers in the rear. The front has 5.70 x 8" pneumatic wheels and the rear is 7" swivel casters. The stair is light enough for two people to easily maneuver. The stair treads and platform are aluminum diamond plate.



PNX-PLBS96AE

Passenger Loading Bridge Stair Specifications

Structure:

- * Main Structure-1 1/4" structural steel tubing
- * Stair treads aluminum diamond plate
- * Platform aluminum diamond plate
- * 5.70 x 8" Pneumatic wheels-front/7" casters in back
- * Rear stabilizer
- * Stair and platform have non-skid surfaces

Platform:

- Main - 45" X 60"
- Intermediate - 36" X 36"

Options:

- Aluminum Canopy
- Wheel Chocks
- Solar Charger
- 110 Volt Lighting

Shipping Dimensions:

- 224" lg. X 96" wide X 72" high
- 3000 Lbs.

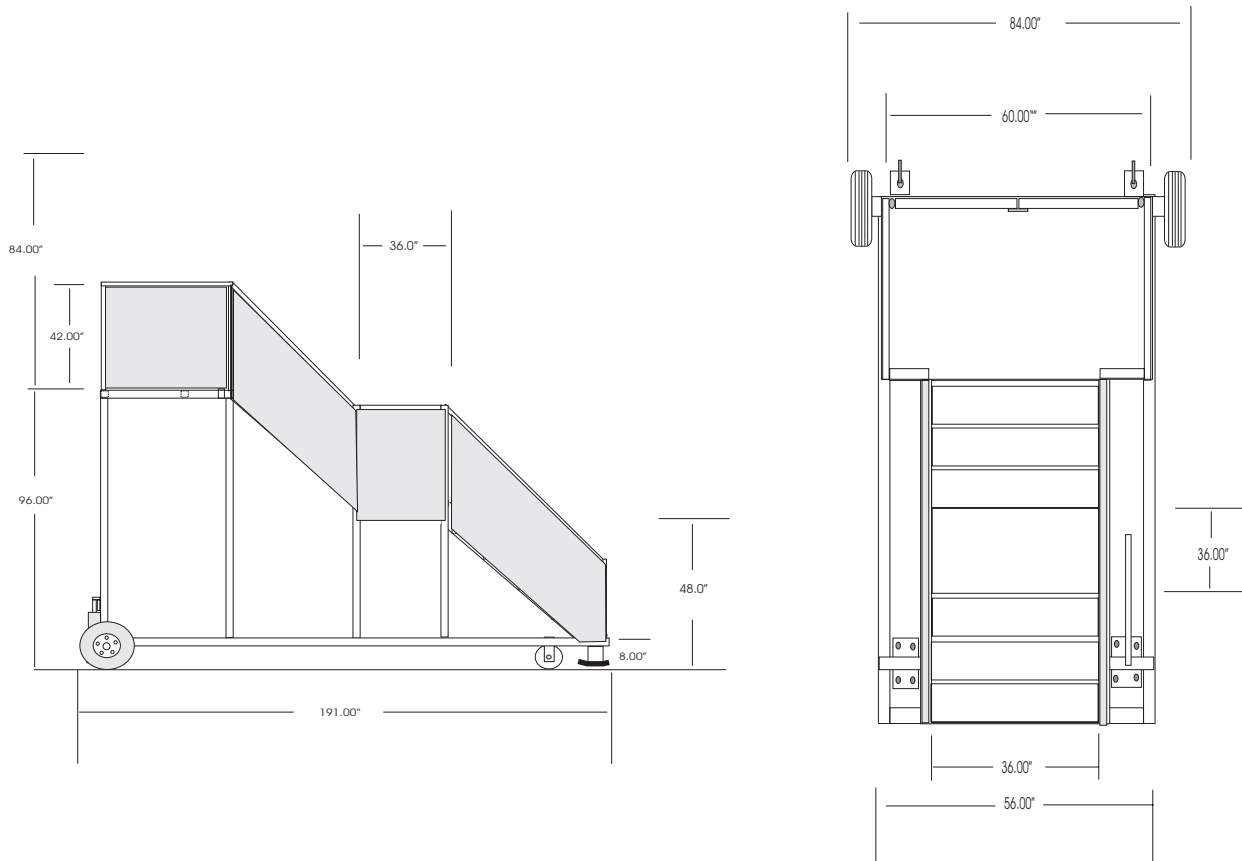

Phoenix Metal Products 3000 Industrial Avenue 3 Ft. Pierce, Fl. 34946

Ph 772-595-6386 Fax 772-595-6389

Email Address: phoenixgse@earthlink.net

URL: www.phoenixgse.com